

# PENN TOWNSHIP SECTION 33 R 12 TWP 10 MORGAN COUNTY, OHIO

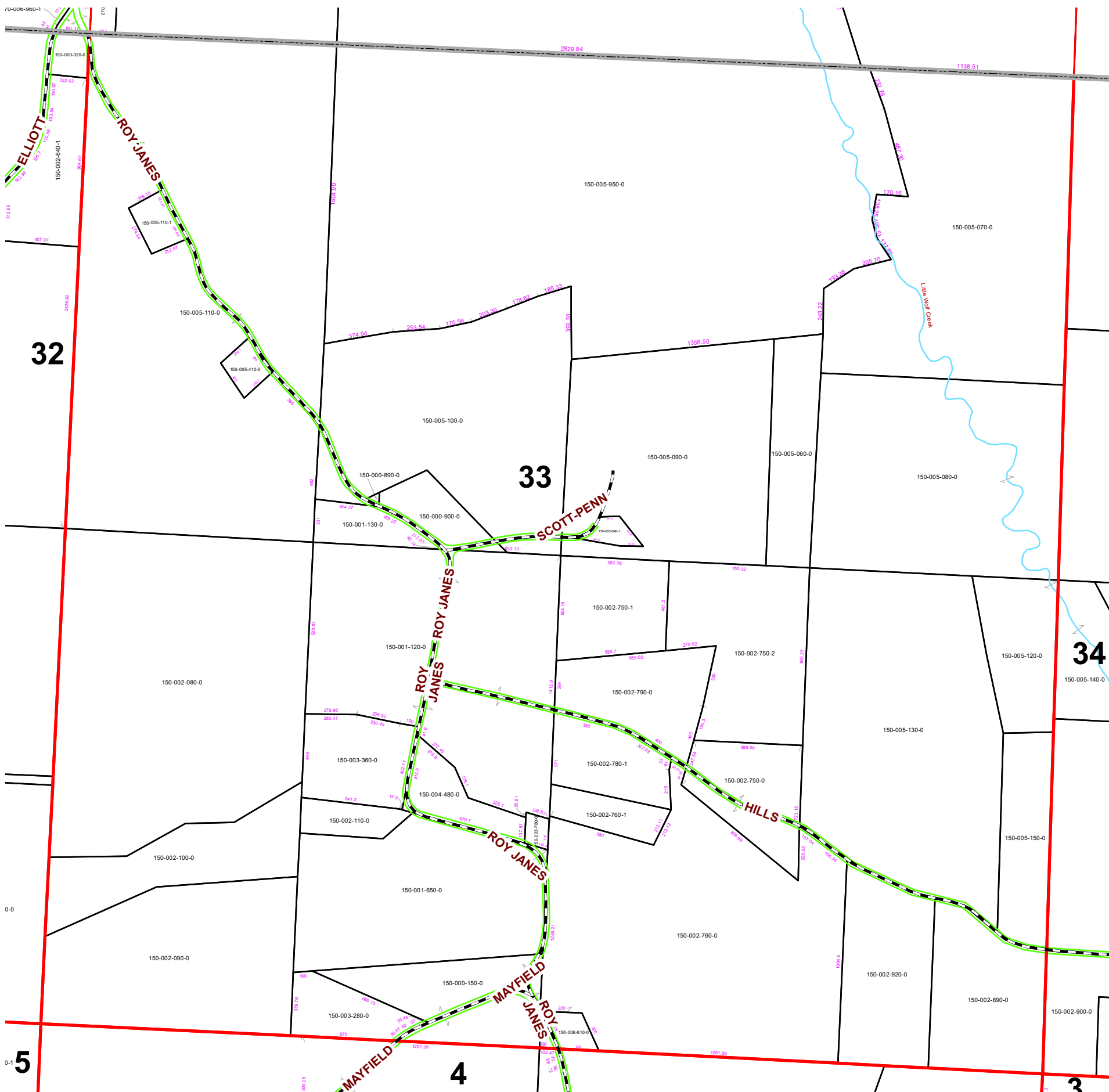

PIN	Owner	LegalDescr	Acres	VOL	PAGE	Survey_Ref
150-003-360-0	BLIND FRED J & KAREN M	R12 T10 S33 SD 33	6.22	D.V 183	785	PEN-0021.pdf
150-002-760-1	CALENDINE ROBERT L & KAYE	R12 T10 S33 SD 39	2.676	OR143	71	PEN-0337.pdf
150-002-780-1	CALENDINE ROBERT L & KAYE	R12 T10 S33 SD 40	5.32	OR143	71	PEN-0052.pdf
150-002-760-0	CLINE JAMES B & AMBER J	R12 T10 S33 SD 12 SUR	43.514	OR227	2588	PEN-0269.pdf
150-000-890-0	COLUMBIA GAS TRANSMISSION CORP	R12 T10 S33 SD 36	0.06	OR91	777	NoSurvey.pdf
150-000-900-0	COLUMBIA GAS TRANSMISSION CORP	R12 T10 S33 SD 37	3.191	OR127	15	NoSurvey.pdf
150-003-780-0	CROUSE RAY C & MARILYN A	R12 T10 S33 SD 29	0.49	D.V 149	179	PEN-0001.pdf
150-004-480-0	CROUSE RAY C & MARILYN A	R12 T10 S33 SD 30 SUR	3.55	OR163	688	PEN-0002.pdf
150-001-650-0	CROUSE RAY C JR & MARILYN A	R12 T10 S33 SD 20	20.48	D.V 188	128	NoSurvey.pdf
150-000-150-0	GSH INVESTMENT HOLDINGS LLC	R12 T10 S33 SD 21	10.145	OR224	1520	NoSurvey.pdf
150-002-750-0	HILL RICKY J & WENDY R	R12 T10 S33 SD 9 SUR	7.002	OR169	467	PEN-0264.pdf
150-002-790-0	HILL RICKY J & WENDY R	R12 T10 S33 SD 31 SUR	7.99	OR169	455	PEN-0010.pdf
150-002-750-2	HILL RICKY J & WENDY R	R12 T10 S33 SD 42 SUR	14.003	OR169	467	PEN-0240.pdf
150-002-750-1	HILL RICKY J & WENDY R	R12 T10 S33 SD 41 SUR	7	OR169	455	PEN-0188.pdf
150-002-890-0	HOOVER LINDA J	R12 T09 S33 SD 11	10	OR12	198	NoSurvey.pdf
150-002-920-0	HOOVER LINDA J	R12 T10 S33 SD 10	10	OR12	198	NoSurvey.pdf
150-003-280-0	KERR BRUCE A TOD-ROBERT HALE &	R12 T10 S33 SD 38	3.985	D.V 178	29	PEN-0044.pdf
150-005-950-0	KING LESLIE L & TERRY L	R12 T10 S33 SD 2	98.986	OR225	272	PEN-0319.pdf
150-001-120-0	LOVE GARY L	R12 T10 S33 SD 8	34.247	OR91	777	PEN-0187.pdf
150-001-130-0	LOVE GARY L	R12 T10 S33 SD 23	2.739	OR91	777	NoSurvey.pdf
150-005-090-1	SCOTT JAN R & JENIFER J	R-12 T-10 S-33 SD 44	0.753	OR232	5563	PEN-0338.pdf
150-005-410-0	SCOTT KAYLA L & SETH M	R12 T10 S33 SD 32 SUR	1.08	OR212	830	PEN-0012.pdf
150-005-150-0	SCOTT KENNY L & JAN R	R12 T10 S33 SD 28 SUR	7	OR219	3074	NoSurvey.pdf
150-005-120-0	SCOTT KENNY L & JAN R	R12 T10 S33 SD 19 SUR	7.8	OR219	3074	NoSurvey.pdf
150-005-130-0	SCOTT KENNY L & JAN R	R12 T10 S33 SD 13 SUR	38.2	OR219	3074	NoSurvey.pdf
150-005-080-0	SCOTT KENNY L & JAN R	R12 T10 S33 SD 1 SUR	32	OR219	3074	NoSurvey.pdf
150-005-090-0	SCOTT KENNY L & JAN R	R12 T10 S33 SD 3 SUR	27.247	OR219	3074	NoSurvey.pdf
150-005-060-0	SCOTT KENNY L & JAN R	R12 T10 S33 SD 25 SUR	6	OR2	261	NoSurvey.pdf
150-005-100-0	SCOTT KENNY L & JAN R	R12 T10 S33 SD 24-26	31.239	OR214	3074	NoSurvey.pdf
150-005-070-0	SCOTT KENNY L & JAN R	R12 T10 S33 SD 27 SUR	40	OR219	3074	NoSurvey.pdf
150-005-110-0	SCOTT KENNY L & JAN R	R12 T10 S33 SD 5 SUR	77.557	OR219	3074	NoSurvey.pdf
150-002-090-0	SCOTT KENNY L & JAN R C/O JAN SC	R12 T10 S33 SD 7	22.22	D.V 191	629	NoSurvey.pdf
150-002-110-0	SCOTT KENNY L & JAN R C/O JAN SC	R12 T10 S33 SD 35	2.05	D.V 191	629	NoSurvey.pdf
150-002-100-0	SCOTT KENNY L & JAN R C/O JAN SC	R12 T10 S33 SD 22	10.39	D.V 191	629	NoSurvey.pdf
150-002-080-0	SCOTT KENNY L & JAN R C/O JAN SC	R12 T10 S33 SD 6	49.61	D.V 191	629	NoSurvey.pdf
150-005-110-1	SCOTT KYLE LEE EDWARD	R12 T10 S33	1.363	OR228	3383	PEN-0331.pdf
150-006-610-0	YORK JOE B & KATHY DARLENE	R12 T10 S33 SD 34	1	D.V 164	774	PEN-0027.pdf

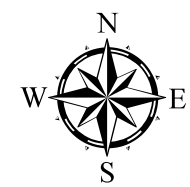

Boundaries			
	Hydro		Section
	Roads		Lot
	County		Township
	Parcel		ROW



Disclaimer: The information that these maps contains is for reference purposes only. Please bring any erros to the attention of the Engineer's Office staff. Thank you

